

May 30

Topic

How to properly adjust Spark Plug gap

Issue

When installing spark plugs, often the incorrect gapping method is used which can cause damage to the spark plug itself most notably, the center electrode.

Solution

Proper feeler-type gauges include a tool allowing gap adjustments to the ground electrode strap while avoiding any pressure being applied to the center electrode tip that could damage the weld or tip itself.

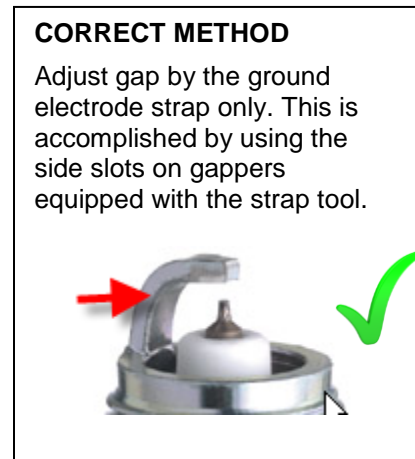

Additional Information

Using the correct gapping tool is the key to ensuring precious metal tip spark plugs are not damaged during the gapping process. There are three key types of gapping tools:

- 1) Slide gapper
- 2) Feeler gauge
- 3) Star Gapper



Ground Strap
Adjusting Tool

The slide gapper was designed primarily for consumer use to adjust gap settings on nickel/ conventional style spark plugs.

The feeler gauge or star gapper is the primary tool used by technicians and if used properly, will not damage precious metal type spark plugs (Iridium, Platinum or Laser series).

